

Client:
Save Our
Heritage,
Concord, MA

Project:
Col. James
Barrett Farm,
448 Barrett's
Mill Rd.
Concord, MA

Frederic C.
Detwiller

Architect &
Preservation
Planner

302 Central St.
Georgetown,
Massachusetts
01833

Tel. 978-352-2819
or 617-640-4935
e-mail:
rick.detwiller@
comcast.net

date: 1/15/2007

scale: as noted

Dwg. Title
Emergency
Repair
Section A - A'

Dwg. No. ER4



NEW
ENGLAND
LANDMARKS

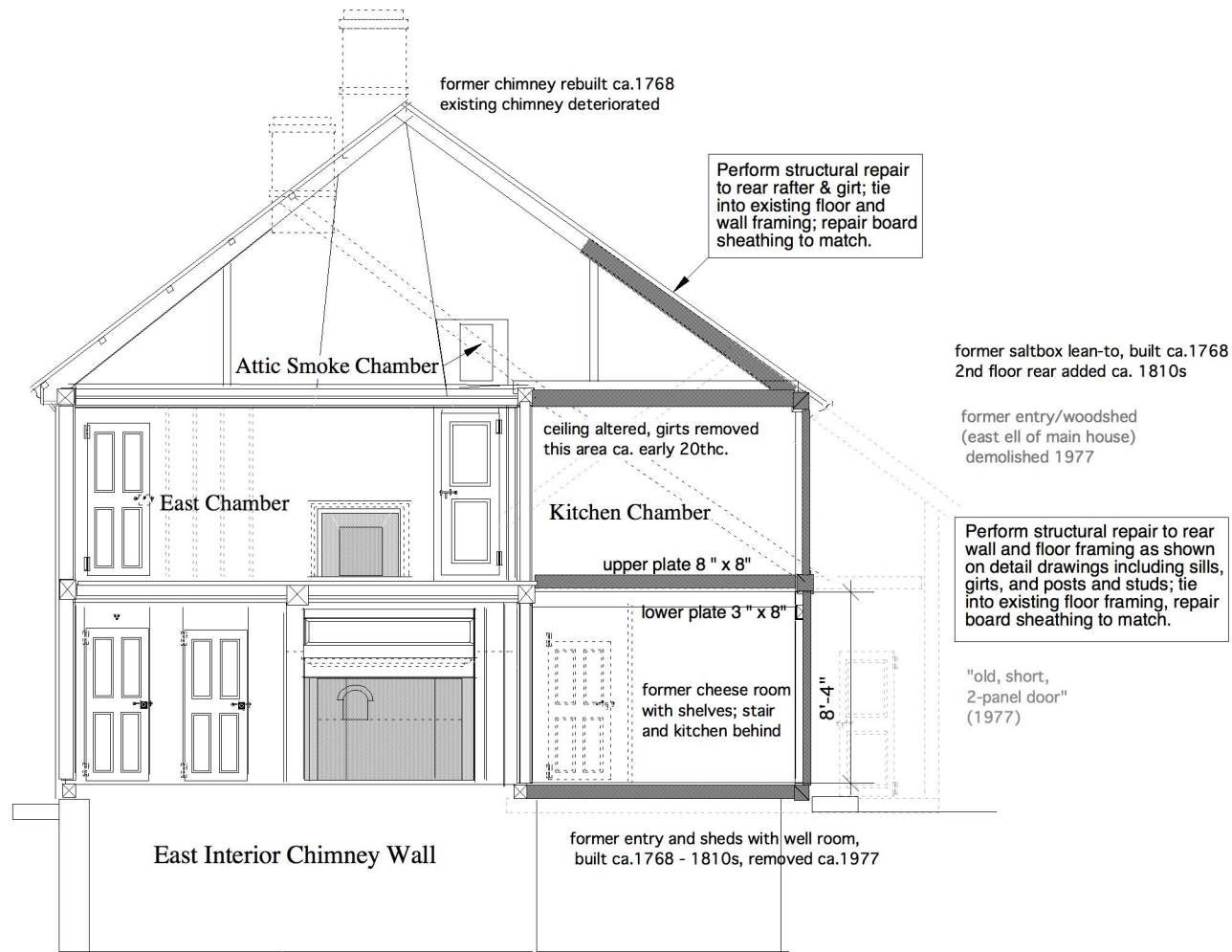

Section A - A' **Schematic Emergency Repair**

■ indicates area of deteriorated framing to be repaired/replaced as specified

Preliminary Draft
scale 0 2 4 feet